



Order form

# Comfort ACTA-Relief LTS back support



Dealer Name\*:

Account #\*:

City, State, Zip\*:

Phone:

Email:

ATP:

Rep Name:

P.O. Number:

Quote Number:

Client Reference\*:

Client Weight\*:

**\*Required field**

Special considerations that need to be addressed here (e.g., diagnosis):

**Notes** | Refer to reference pages at end of order form for additional information and images.

## ACTA-Relief LTS Back Support

HCPCS coding: E2620 Positioning back, planar with lateral supports. Part number: ARLTS-BSXXWYYL.

Length	22"	\$1,115.00	\$1,115.00	\$1,115.00	\$1,115.00
	20"	\$1,115.00	\$1,115.00	\$1,115.00	\$1,115.00
	18"	\$1,115.00	\$1,115.00	\$1,115.00	\$1,115.00
	16"	\$1,115.00	\$1,115.00	\$1,115.00	\$1,115.00
	14"	\$1,115.00	\$1,115.00	\$1,115.00	\$1,115.00
	12"	\$1,115.00	\$1,115.00	\$1,115.00	\$1,115.00
		14"	16"	18"	20"
Width					

12" length requires 2 point hardware

**Cover** | Required, choose one.

COMFORT-TEK

**COMFORT-TEK**

For fluid protection, an easily cleaned surface

NC

STRETCH-AIR

**STRETCH-AIR**

For comfort and heat dissipation

NC

**Hardware** | Required, choose one. Includes moldable support and fixed hardware.

<b>Quick Release</b>	Quick Release 2 Point (Q-COMPASS)	Quick Release 4 Point (Q-COMPASS4)	NC
<b>Fixed</b>	Fixed 2 Point (NQ-COMPASS)	Fixed 4 Point (NQ-COMPASS4)	NC
<b>Power Mount</b>	Permobil w/ Corpus 3G (PMB-PERMOBIL)	Quantum w/ Tru Balance 3 (PMB-QUANTUM)	\$52.00
	Quickie w/ 3.7 Power (PMB-QUICKIE)	Avid Rehab w/ Power T & R (PMB-AVID)	
	ROVI w/ Motion Concepts (PMB-ROVI)		

*\*Using Power Mount hardware on ROVI requires mounting to the recessed planar interface plate available when ordering the Motion Concepts seating system. Drilling is required for mounting.*

**Lateral trunk support** | Required, choose one. Includes moldable support and fixed hardware.

<b>3" L x 4" D</b>	COMFORT-TEK (LAT-3L4D-COMFORT-TEK)	STRETCH-AIR (LAT-3L4D-STRETCH-AIR)	NC
<b>4" L x 5" D</b>	COMFORT-TEK (LAT-4L5D-COMFORT-TEK)	STRETCH-AIR (LAT-4L5D-STRETCH-AIR)	NC
<b>4" L x 6.5" D</b>	COMFORT-TEK (LAT-4L6D-COMFORT-TEK)	STRETCH-AIR (LAT-4L6D-STRETCH-AIR)	NC
<b>5" L x 6.5" D</b>	COMFORT-TEK (LAT-5L6D-COMFORT-TEK)	STRETCH-AIR (LAT-5L6D-STRETCH-AIR)	NC

**Additional lateral trunk support hardware** | Optional, priced per selection.

<b>Swing-away hardware</b>	Left (BL-LTS-GT2SAS-LH)	Right (BL-LTS-GT2SAS-RH)	\$339.00	E1028
	Extra Left (BL-LTS-GT2SAS-LH)	Extra Right (BL-LTS-GT2SAS-RH)		
<b>Extra hardware link</b>	Left (BL-LTS-GT2LINK)	Right (BL-LTS-GT2LINK)	\$43.00	
	Extra Left (BL-LTS-GT2LINK)	Extra Right (BL-LTS-GT2LINK)		
<b>Hardware cover</b>	Left (BL-LTS-HCOVER)	Right (BL-LTS-HCOVER)	\$31.00	
	Extra Left (BL-LTS-HCOVER)	Extra Right (BL-LTS-HCOVER)		

**Accessories** | Optional

PV-FLAP	<b>Privacy Flap</b> <i>Connects with hook &amp; loop attachment</i>	\$44.00
---------	--	---------

**BodiLink premium head support & hardware**

*Optional, if selecting must choose pad size, foam selection, cover, and mounting hardware.*

**Pad size and foam selection**

	Soft	Extra soft		
<b>Pad size</b>				
6"W x 3"L	BL-HSP1-6W3L	BL-HSP2-6W3L	\$269.00	E0955
8"W x 4"L	BL-HSP1-8W4L	BL-HSP2-8W4L	\$269.00	E0955
10"W x 5"L	BL-HSP1-10W5L	BL-HSP2-10W5L	\$269.00	E0955
12"W x 5"L	BL-HSP1-12W5L	BL-HSP2-12W5L	\$269.00	E0955
14"W x 5"L	BL-HSP1-14W5L	BL-HSP2-14W5L	\$269.00	E0955
18"W x 5"L	BL-HSP1-18W5L	BL-HSP2-18W5L	\$269.00	E0955

**Cover options**

COMFORT-TEK	<b>COMFORT-TEK</b> <i>For fluid protection &amp; an easily cleaned surface</i>	NC
STRETCH-AIR	<b>STRETCH-AIR</b> <i>For comfort &amp; heat dissipation</i>	NC
GLIDEWEAR	<b>GlideWear</b> <i>For skin protection &amp; shear reduction. NOT fluid resistant</i>	\$30.00

**PT hardware, removable** | *Mid 8 and Lat 8 recommended for ACTA-Relief back support.*

BL-HS-PT1RMMID6	<b>Mid 6</b>	\$254.00	E1028
BL-HS-PT1RMLAT6	<b>Lat 6</b>	\$295.00	E1028
BL-HS-PT1RMMID8	<b>Mid 8</b>	\$254.00	E1028
BL-HS-PT1RMLAT8	<b>Lat 8</b>	\$295.00	E1028
BL-HS-PT1RMMAX8	<b>Max 8</b>	\$372.00	E1028

**Stem length option** | *For removable PT hardware only*

HS-STEM-7	<b>Standard 7" stem</b>	NC
HS-STEM-3	<b>3" stem (recommended for use with power mounting where there may be constraints)</b>	NC

**PT hardware, flip down** | *Flip down hardware has 7" stem. Mid 8 and Lat 8 recommended for ACTA-Relief back support.*

BL-HS-PT1FDMID6	<b>Mid 6</b>	\$310.00	E1028
BL-HS-PT1FDLAT6	<b>Lat 6</b>	\$353.00	E1028
BL-HS-PT1FDMID8	<b>Mid 8</b>	\$310.00	E1028
BL-HS-PT1FDLAT8	<b>Lat 8</b>	\$353.00	E1028
BL-HS-PT1FDMAX8	<b>Max 8</b>	\$405.00	E1028

**Mounting option** | *Posterior A used for ACTA-Relief with power mount only. ACTA-Relief bracket includes mounting block and used for non-power mount.*

HS-MB-POSTA	<b>Posterior A</b>	NC
HS-MB-AR14W	<b>ACTA-Relief 14W bracket with mounting block</b>	\$84.00
HS-MB-AR16W	<b>ACTA-Relief 16W bracket with mounting block</b>	\$84.00
HS-MB-AR18W	<b>ACTA-Relief 18W bracket with mounting block</b>	\$84.00
HS-MB-AR20W	<b>ACTA-Relief 20W bracket with mounting block</b>	\$84.00

**Additional hardware options** | *Priced per selection.*

<b>Extra link for PT hardware</b>	Extra 2" link (BL-HS-PT1LINK2)	Extra 3" link (BL-HS-PT1LINK3)	\$65.00
	Extra 4" link (BL-HS-PT1LINK4)		
BL-HS-52WINGA1	<b>Tool-less wing lock for PT hardware</b> <i>Enter desired number.</i>		\$25.00
BL-HS-SPCRA	<b>1/4 Spacer Plate</b>		\$43.00

**Mounting bracket** | *Bracket only, does not include mounting block.*

BL-HS-AR14W	<b>ACTA-Relief 14W bracket</b>	\$173.00
BL-HS-AR16W	<b>ACTA-Relief 16W bracket</b>	\$173.00
BL-HS-AR18W	<b>ACTA-Relief 18W bracket</b>	\$173.00
BL-HS-AR20W	<b>ACTA-Relief 20W bracket</b>	\$173.00

## Additional Order Instructions (for Permobil):

## Notes & Comments (not for Permobil):

## Chair Order Policy:

You are highly encouraged to contact Permobil Sales with ANY questions regarding proper completion of our order forms at 1-800-736-0925. The order cannot be processed without the following:

- The client's name or code and the client's weight
- The order form must also be signed by a person authorized by your company to acknowledge the items selected. Permobil is not responsible for configuration or size discrepancies resulting from customer errors on the order form.
- Order confirmations will be provided by Permobil summarizing the items selected. Please review this carefully.
- Once the order is shipped, any changes are subject to the returns policy and may be prohibited.

## Order Acknowledgement:

I, \_\_\_\_\_, am an agent of the medical equipment provider named on this order form and I have the authority to contract for the purchase of powered wheelchairs and related parts on behalf of said provider. I acknowledge that I have reviewed this order and that it is complete and accurate to the best of my knowledge. I further acknowledge that any changes to this order after submission of this order form are subject to the returns policy and may carry additional charges.

Signed: \_\_\_\_\_

Printed Name: \_\_\_\_\_

Title: \_\_\_\_\_

Date: \_\_\_\_\_

*NOTE: All specifications and prices are subject to change without notice. Please note that prices displayed are only valid if ordered with the wheelchair. Any parts ordered for service or future alterations will carry different pricing and warranty. The HCPCS codes provided are not intended to be billing or legal advice, rather our interpretation of the code definitions. Use of the codes does not ensure coverage or payment for the item. For coverage information, verify the policy of the appropriate payer.*

## References

### Section 1 | Hardware options

#### Compass 4 quick release

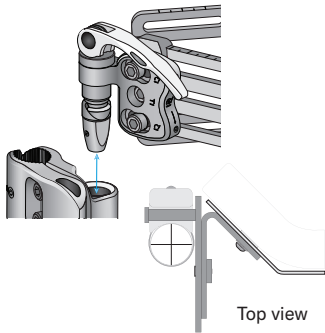

#### Compass 4 fixed

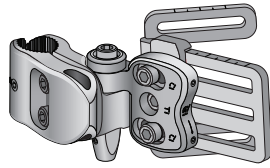

#### Compass power mount

Power mount hardware has 8" of height adjustment in ½" increments without using tools.

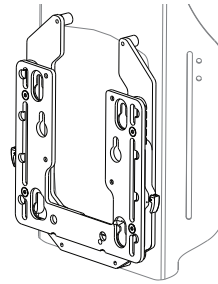

#### 4-point

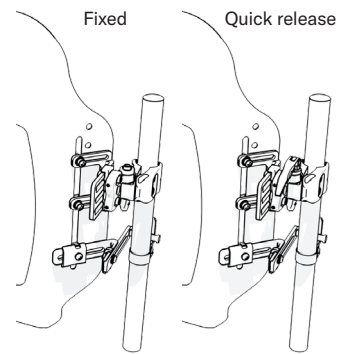

### Section 2 | Accessories

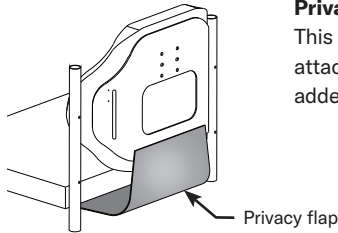

#### Privacy flap

This flap connects with hook & loop attachment between the seat and the back for added privacy.

Privacy flap

### Section 3 | BodiLink lateral trunk support hardware

#### GT2 mounting hardware, slot mount, swing-away

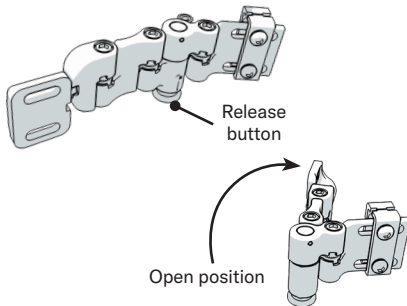

#### GT2 mounting hardware, slot mount, fixed

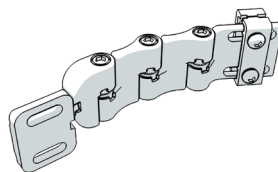

#### GT2 mounting hardware, track mount, swing away

Track mount hardware is only available when using Compass 4 hardware. If using compass power mount hardware, select slot mounting hardware.

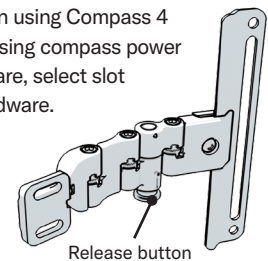

### Section 4 | BodiLink lateral trunk support pads

#### Premium pads, supportive

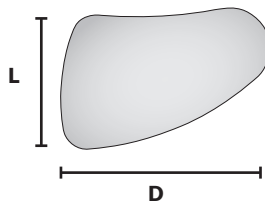

#### Premium pads, active

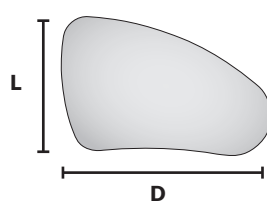

#### Basic pads, supportive

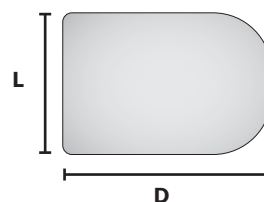

#### Basic pads, active

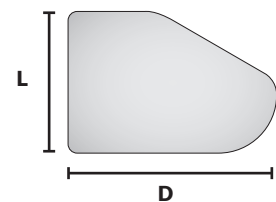

## Section 5 | Bodilink lateral trunk support additional hardware options

### Extra hardware links

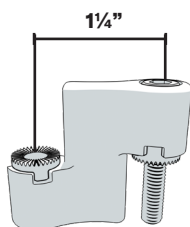

### Long mounting bracket

Adds 1" of additional adjustment per bracket

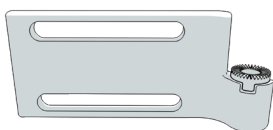

### Hardware cover

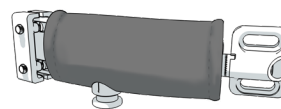

## Section 6 | Bodilink head support pads

### Basic pad sizes

W		L	
L	6W x 5L	L	12W x 6L
L	8W x 5L	L	14W x 6L
L	10W x 6L	L	18W x 6L
W		W	

Length(L) refers to the actual dimension of the support from bottom to top edge



Basic head support pads can be formed to any shape using the moldable steel insert inside the pad.

### Premium pad sizes

W		L	
L	6W x 3L	L	12W x 5L with adjustable wings
L	8W x 4L	L	14W x 5L with adjustable wings
L	10W x 5L with adjustable wings	L	18W x 5L with adjustable wings
W		W	

Length(L) refers to the actual dimension of the support from bottom to top edge



Premium head support pad angles can be formed by adjusting the plates in the pad

## Section 7 | BodiLink head support hardware options

### GT hardware, removable

#### Range of motion

GT model	Total # of links	Total link length	Max. anterior reach	Max. posterior reach	Max. lateral reach
LAT	5	10.5"	10"	2"	7.5"
MID	3	8.5"	8"	2"	N/A

GT hardware, LATERAL



GT hardware, MID-LINE



### BodiLink head support hardware: PT hardware, removable

#### Range of motion

PT model	Total # of links	Total link length	Max. anterior reach	Max. posterior reach	Max. lateral reach
MID 6	2	6"	5.5"	1"	N/A
LAT 6	3	6"	5.5"	1"	6"
MID 8	2	8"	7.5"	1"	N/A
LAT 8	3	8"	7.5"	1"	8"
MAX 8	4	8"	7.5"	3"	8"

PT hardware, MID 6

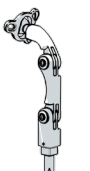

PT hardware, MID 8

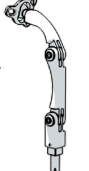

PT hardware, LAT 6

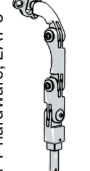

PT hardware, LAT 8



PT hardware, MAX 8



**BodiLink head support hardware: PT hardware, removable stem length option**

3" stem is recommended for use with power mounting where there may be special constraints with power chair functions

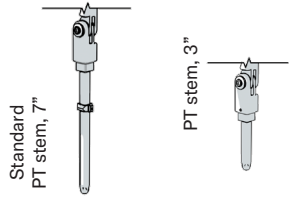

**Mounting options**

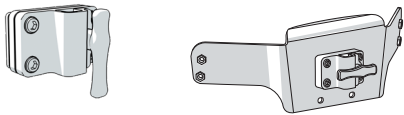

**Mounting block posterior A**  
For Acta-Back®, Acta-Embrace™, Visco-Back, and Acta-Relief with Power Mount Only

**Bracket with mounting block-ACTA-RELIEF™**  
18W Shown Above For Non-Power Mount Only.

**Extra hardware**

¼" spacer plate

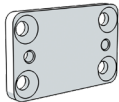

Extra links: 2", 3", 4"

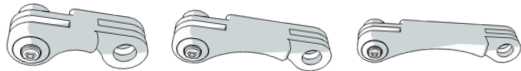

Tool-less wing lock

